

APPLICATIONS

The GRUNDFOS CM pumps are designed to cover a wide variety of applications, ranging from small domestic installations to large industrial systems

CONSTRUCTION FEATURES

Compact design with pump and motor close coupled. Single phase motors are fitted with thermal overload protection. Axial suction and radial discharge ports. Front housing made of cast iron and impellers made of 304 stainless steel pump mounted on a base plate for ease of installation

Pump Liquids: Clean, thin, non-aggressive liquids without solid particles and fibre.

Liquid temperature: 0°C to 90°C

Max. Operating pressure: 10bar

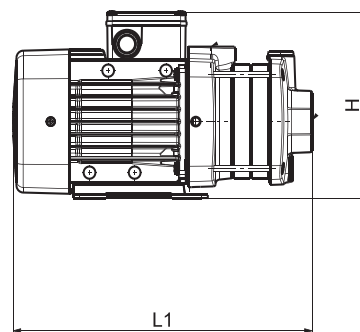
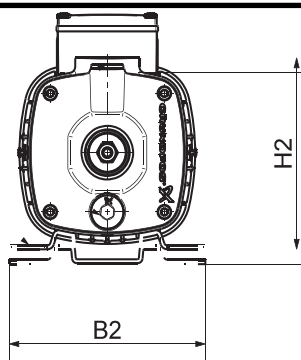
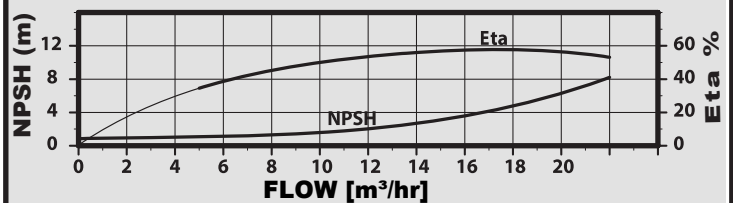
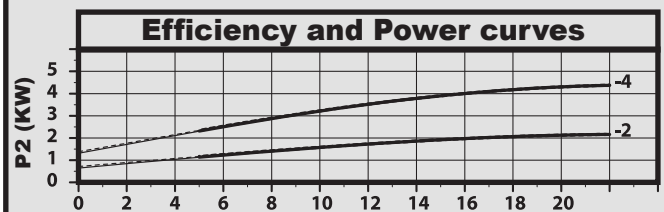
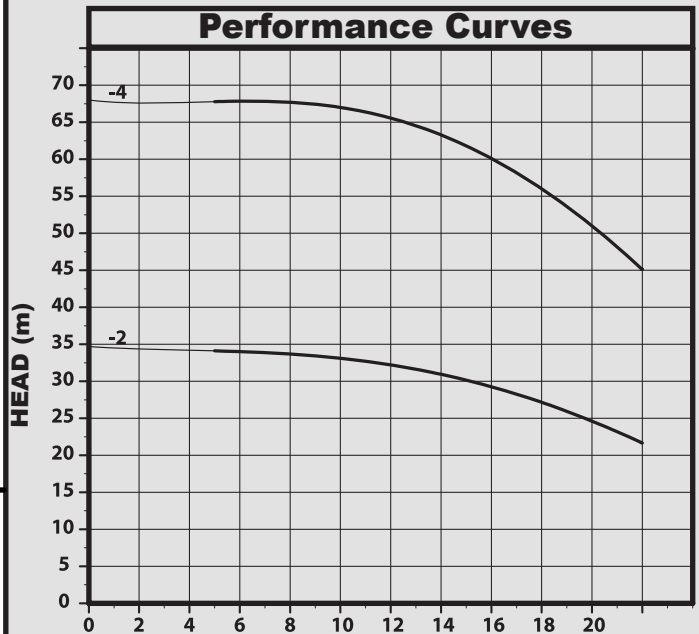

TECHNICAL DATA

Pump Type	1x415V kW	Operating Current	Start Current	Inlet	Outlet	DIMENSIONS(mm)			Weight (kg)
						B2	H2	L1	
CM15-2	2.2	4.9	36	2"		199	245	461	29
CM15-4	5.8	11.4	106			228	257	590	34