



APPLICATIONS

The CR pumps are non self priming verticle multi-stage pumps suitable for a wide range of applications including water transfer, irrigation, boosting and industrial use

CONSTRUCTION FEATURES

The pump consists of a base and a pump head. The chamber stack and the sleeve are secured between the base and the pump head by means of staybolts. The base has suction and discharge ports at the same level(in-line). All pumps are fitted with a maintainance free mechanical shaft. The pump is fitted with a totally enclosed fan-cooled 2 pole Grundfos standard motor with principal dimensions to EN standards. CRN version available for aggressive liquids and CRE version with frequency controlled motors for applications characterized by demand of variable flow at constant pressure

Pump Liquids: Clean, thin, non-aggressive liquids without solid particles and fibre.

Liquid temperature: -20°C to 120°C

Ambient temperature: 60°C max.

Max. Operating pressure: 25bar

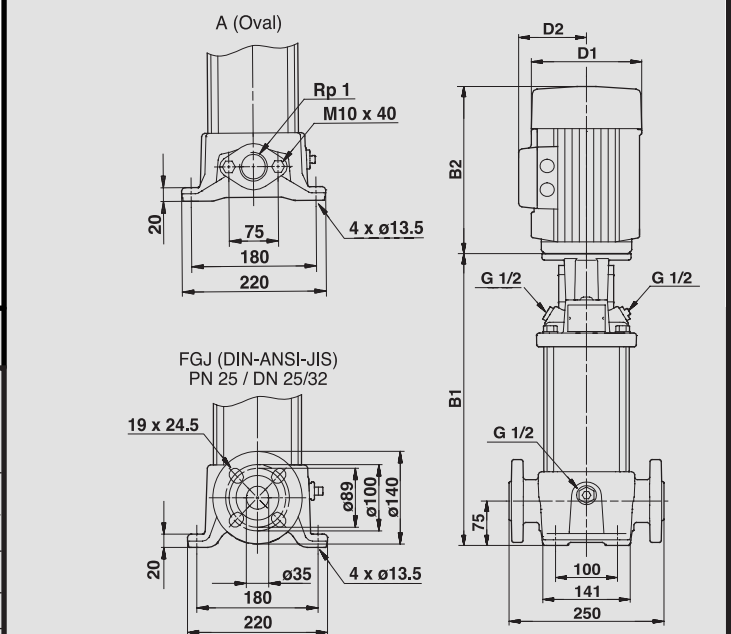
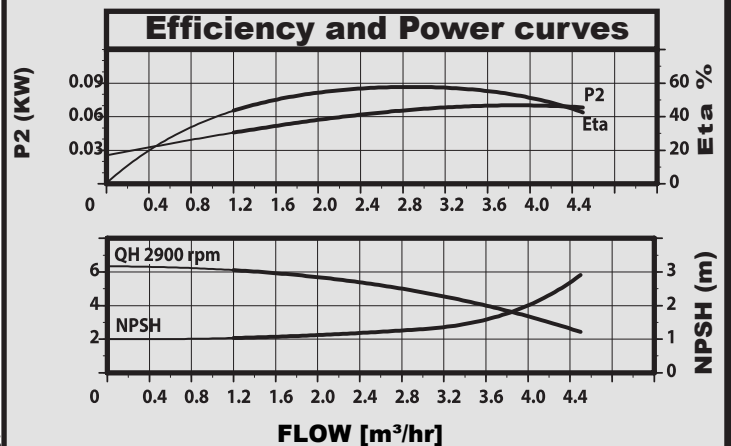
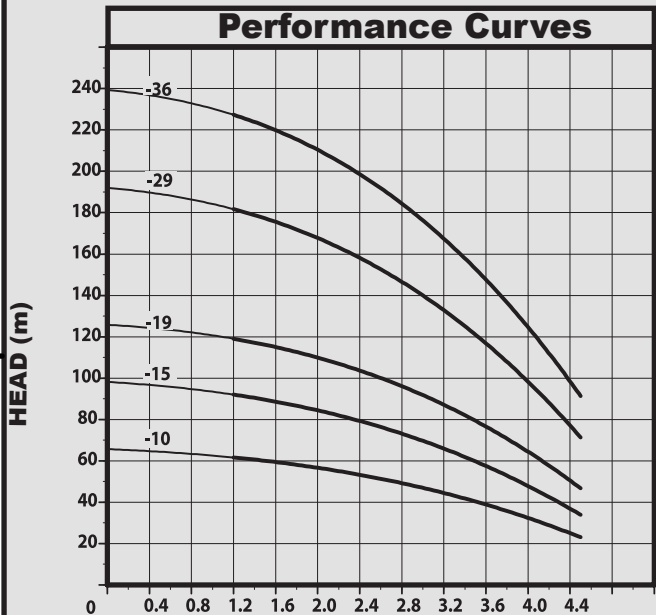

TECHNICAL DATA

| Pump Type | kW | Full Load Current(A) | DIMENSIONS(mm) | | | Weight (kg) |
|-----------|------|----------------------|----------------|---------|-----|-------------|
| | | | B1 | B1 + B2 | D1 | |
| CR 3-10 | 0.75 | 1.9 | 411 | 642 | 141 | 28 |
| CR 3-15 | 1.10 | 2.6 | 509 | 752 | 141 | 32 |
| CR 3-19 | 1.50 | 3.2 | 589 | 870 | 178 | 41 |
| CR 3-29 | 2.20 | 4.5 | 769 | 1090 | 178 | 46 |
| CR 3-36 | 3.0 | 6.3 | 899 | 1234 | 198 | 55 |