

TAFLO

IDB40

PERIPHERAL IMPELLER PUMP

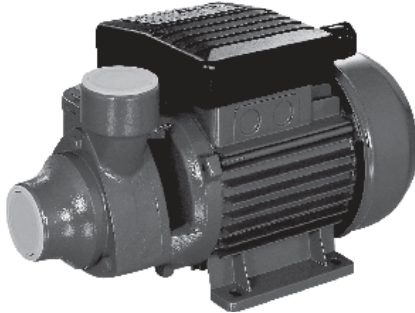

Performance Curves

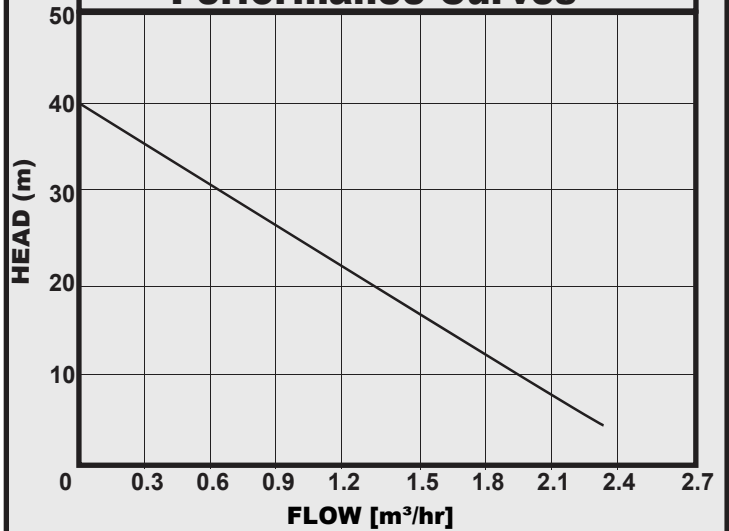

APPLICATIONS

The TAFLO IDB40 is a peripheral impeller design centrifugal pump suitable for domestic water supply systems and small gardening applications.

CONSTRUCTION FEATURES

Cast iron pump body, brass impeller and graphite/ceramic mechanical seal. Induction motor, closed and cooled with external ventilation built-in thermal & current overload protection.

Motor Protection: IP44

Insulation class: B

Terminal box protection: IP55

Liquid quality requirements: clean free from solids and abrasive substances.

Temperature: 0°C to 40°C

Maximum suction depth: 8 m at sea level

Maximum operating pressure: 8bar

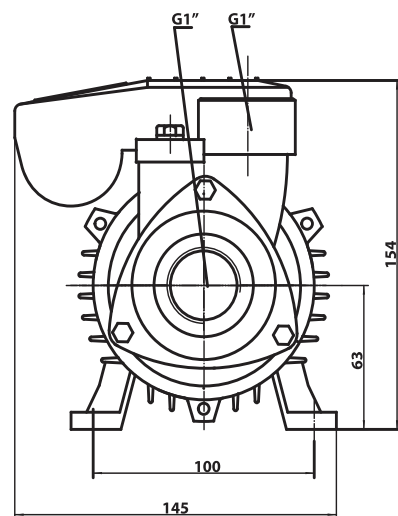
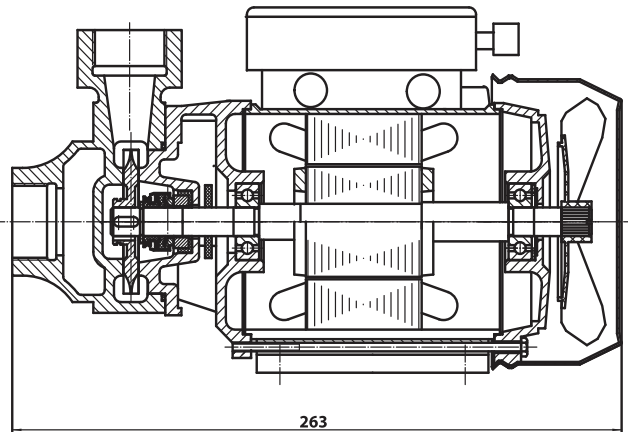

TECHNICAL DATA

MODEL	VOLTAGE	kW	HP	Amps	DNA	DNM	WEIGHT KG
IDB40	240V	0.37	0.5	1.9	1"	1"	6.3