

TAFLO

QX

CONSTRUCTION PUMP



Performance Curves

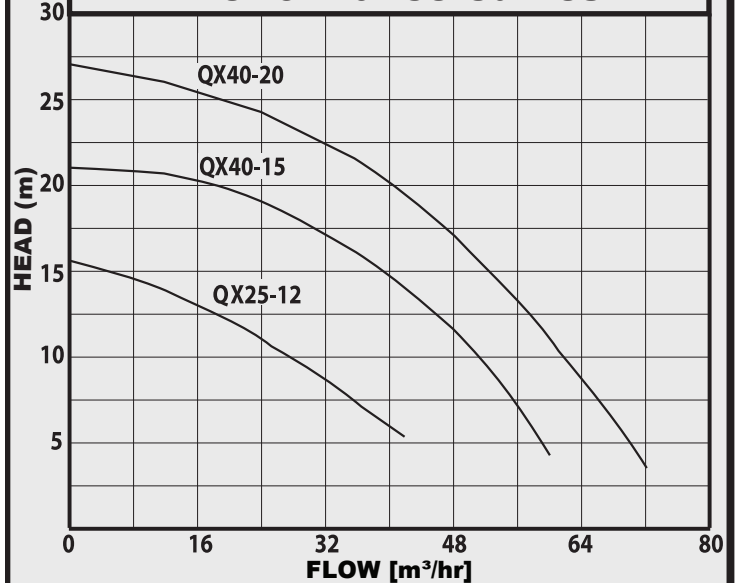

APPLICATIONS

The TAFLO QX pump is wear resistant submersible pump ideal for pumping dirty water mixed with sand and solids and are ideal for construction sites, storm water and open wells.

CONSTRUCTION FEATURES

- Open Impeller made of PTMG materials or ductile iron material.
- Anti-corrosion and rust-proof aluminium pump body
- Fitted with float switch for automatic level control(single phase version)
- Jacketed motor that maximizes cooling and allows for draining of water upto the bottom of the pump
- Double sided mechanical seal made of carbon and silicon carbide
- Built in thermal overload relay(single phase version)
- Supplied with 10m H07RN-F Submersible cable.

Pumped liquid: Waste water containing sand

Temp: 0°C to 40°C

Max. operating pressure: 3 bar

Max. Immersion depth: 7 m

Insulation: B class, IP68 Protection

TECHNICAL DATA

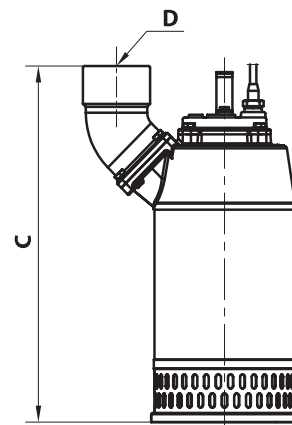
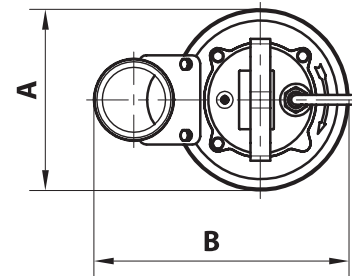

MODEL	VOLTAGE	kW	HP	Dimensions (mm)				WEIGHT KG
				A	B	C	Outlet	
QX25-12-1.5AL	240V	1.5	2	230	320	550	2"	38
QX40-15-3AL	415V	3	4	230	340	610	4"	48
QX40-20-3.7AL	415V	3.7	5	230	340	610	4"	50